

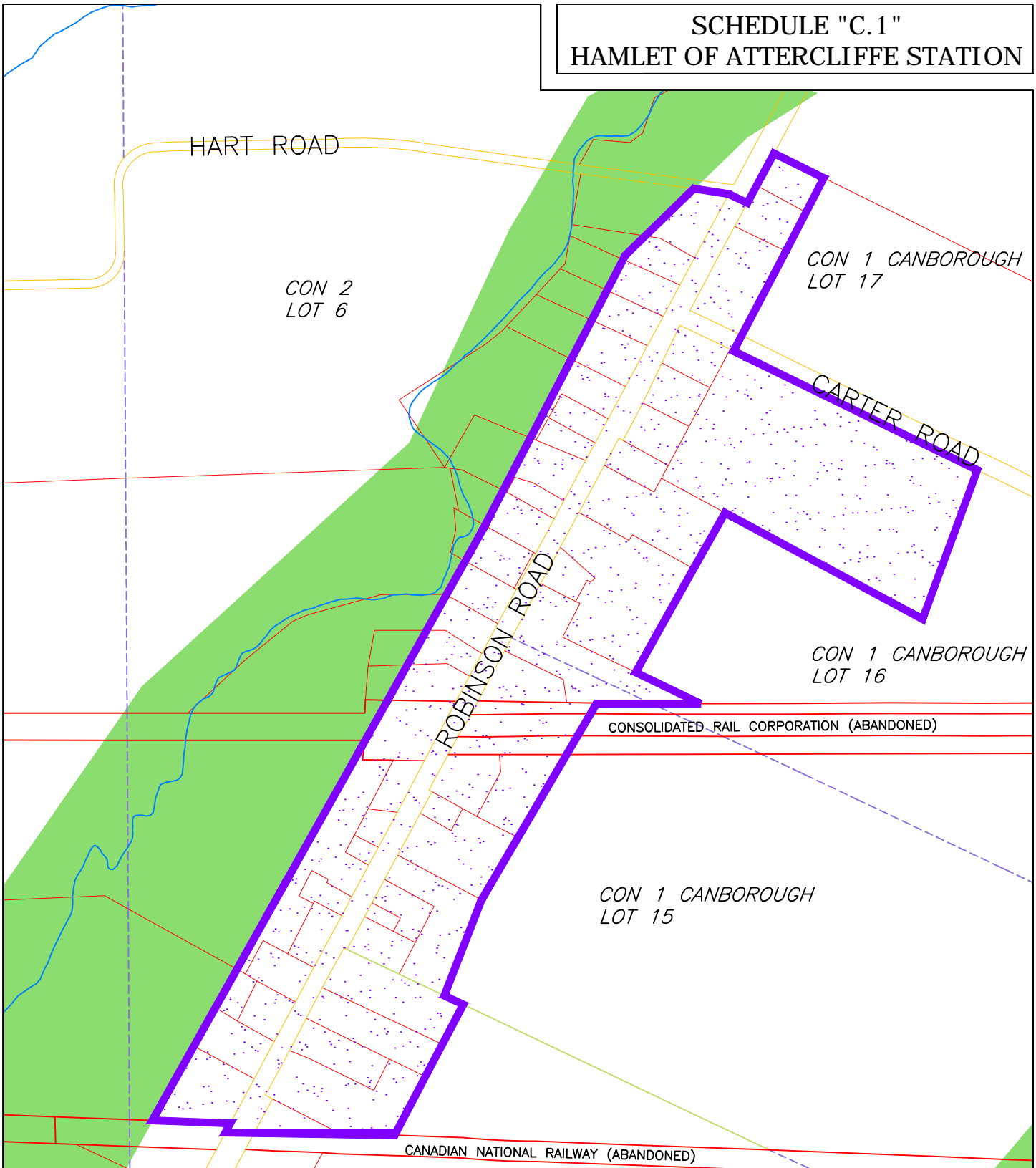





**SCHEDULE "C.1"
HAMLET OF ATTERCLIFFE STATION**



LEGEND:

- | | |
|--|--|
|  CORE NATURAL ENVIRONMENT AREAS |  AGRICULTURE |
|  RIVERINE HAZARD LANDS |  WATER COURSE |
|  HAMLET | |

**HALDIMAND COUNTY
OFFICIAL PLAN**

DECISION DATE: JUNE 8, 2009



1 IN = 150 METRES



SCHEDULE "C.2"
HAMLET OF BLACKHEATH

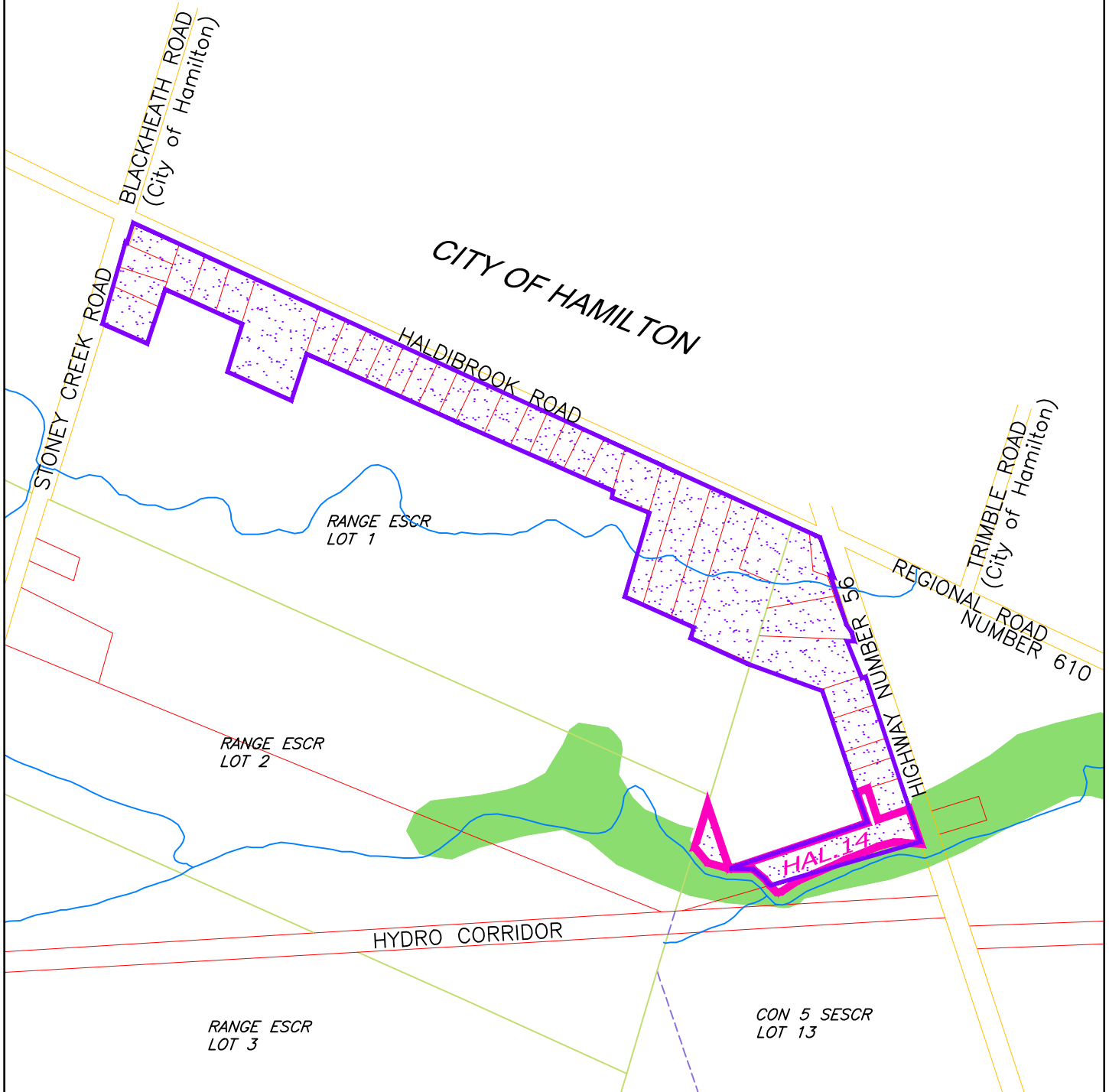

LEGEND:

CORE NATURAL ENVIRONMENT AREAS



RIVERINE HAZARD LANDS



HAMLET



AGRICULTURE



SITE SPECIFIC POLICY



WATER COURSE

HALDIMAND COUNTY
OFFICIAL PLAN

DECISION DATE: JUNE 8, 2009



1 IN = 200 METRES



SCHEDULE "C.3" HAMLET OF BYNG

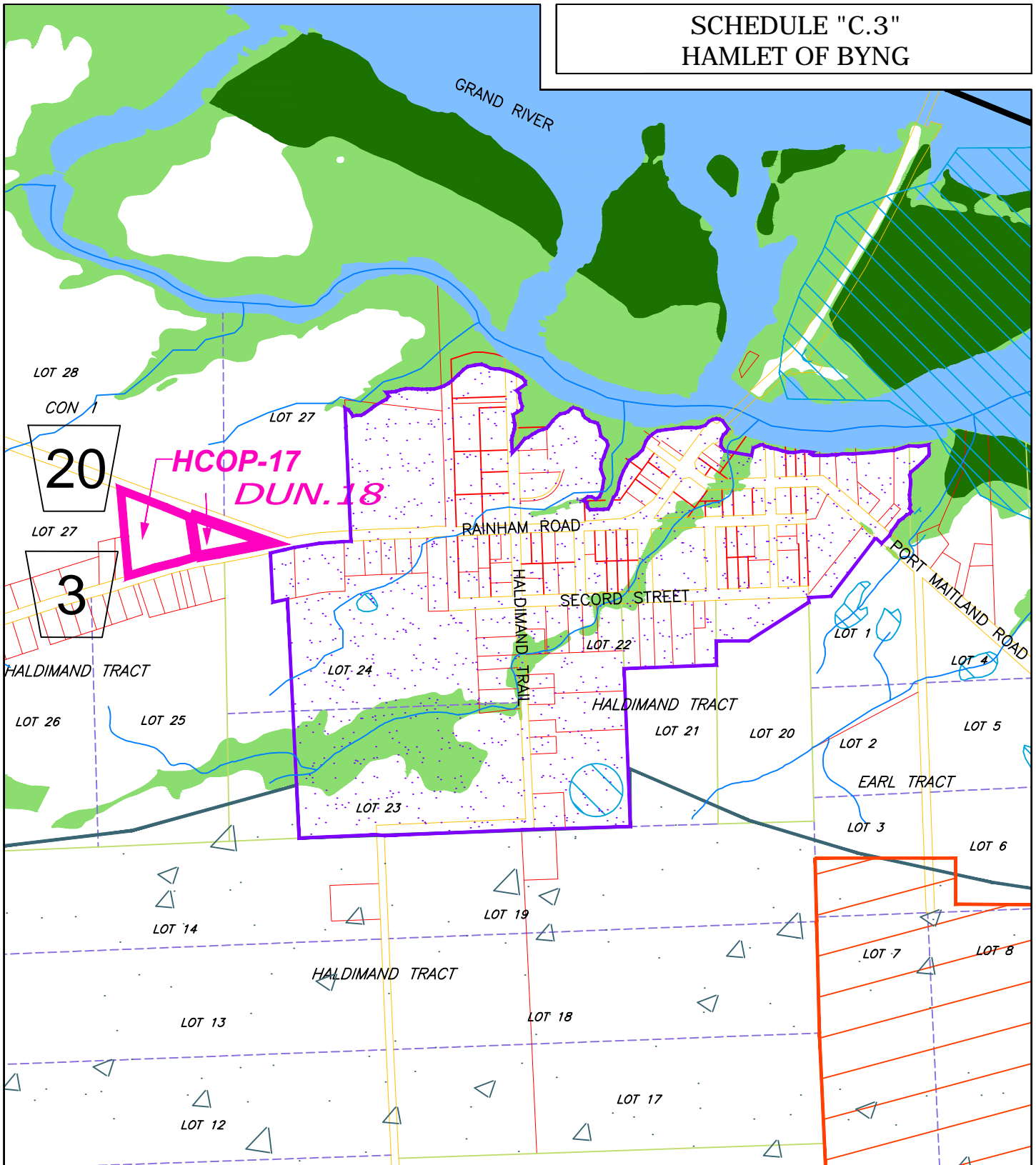

LEGEND:

CORE NATURAL ENVIRONMENT AREAS

- PROVINCIAL SIGNIFICANT WETLANDS
- RIVERINE HAZARD LANDS

NATURAL ENVIRONMENT AREAS

- NATURAL ENVIRONMENT/WETLAND AREAS

- HAMLET

- AGRICULTURE

- SITE SPECIFIC POLICY

- MINERAL AGGREGATE RESOURCE AREAS

- LICENCED AGGREGATE AREA

- WATER COURSE

HALDIMAND COUNTY OFFICIAL PLAN

DECISION DATE: JUNE 8, 2009







1 IN = 250 METRES

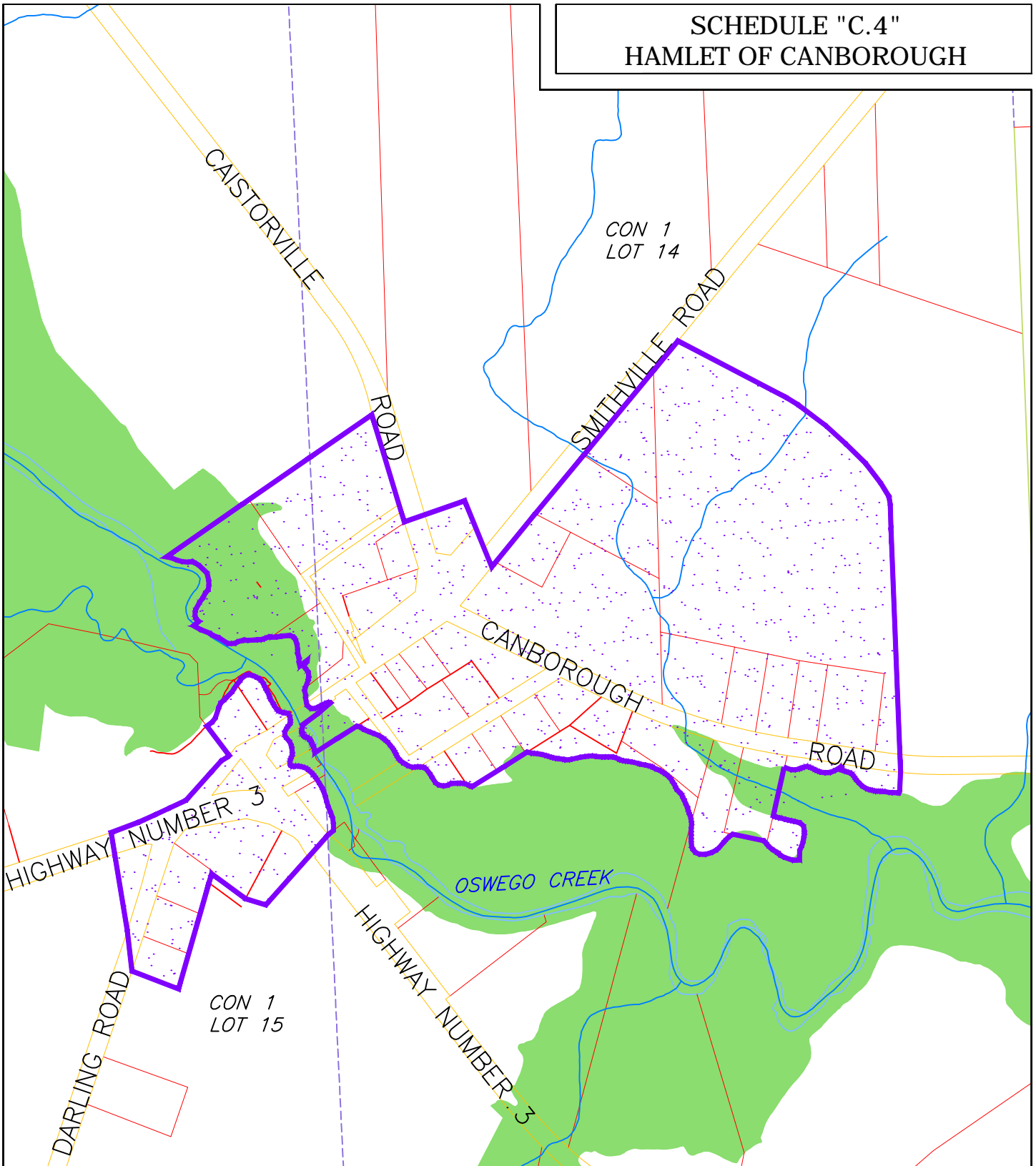

SCHEDULE "C.4"
HAMLET OF CANBOROUGH



LEGEND:

- | | |
|--|--|
|  CORE NATURAL ENVIRONMENT AREAS |  AGRICULTURE |
|  RIVERINE HAZARD LANDS |  WATER COURSE |
|  HAMLET | |

HALDIMAND COUNTY
OFFICIAL PLAN

DECISION DATE: JUNE 8, 2009



1 IN = 150 METRES



**SCHEDULE "C.5"
HAMLET OF CANFIELD**

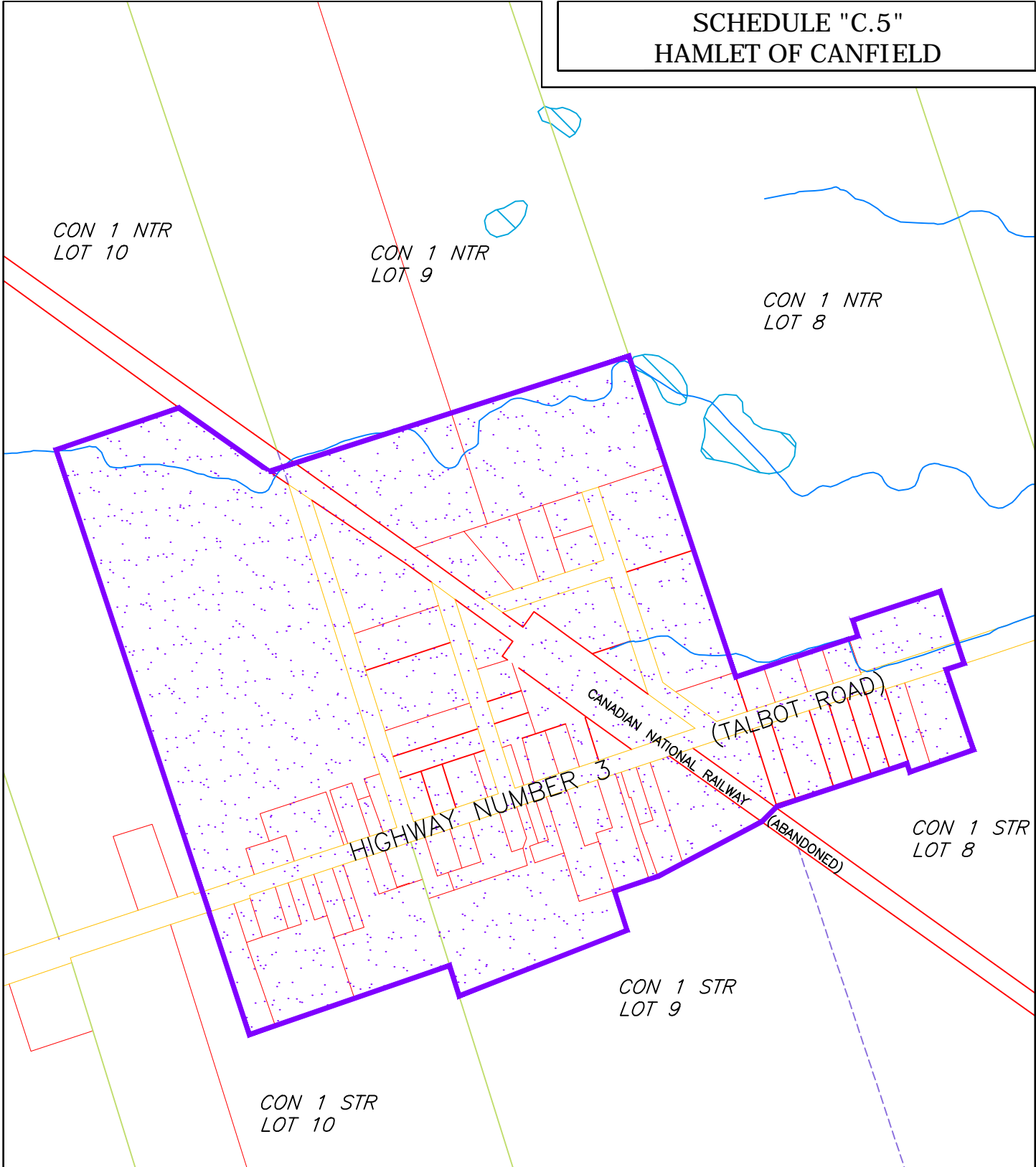

LEGEND:

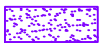

HAMLET



WATER COURSE



AGRICULTURE

NATURAL ENVIRONMENT AREAS



NATURAL ENVIRONMENT/WETLAND AREAS

**HALDIMAND COUNTY
OFFICIAL PLAN**

DECISION DATE: JUNE 8, 2009



1 IN = 150 METRES



**SCHEDULE "C.6"
HAMLET OF CHEAPSIDE**

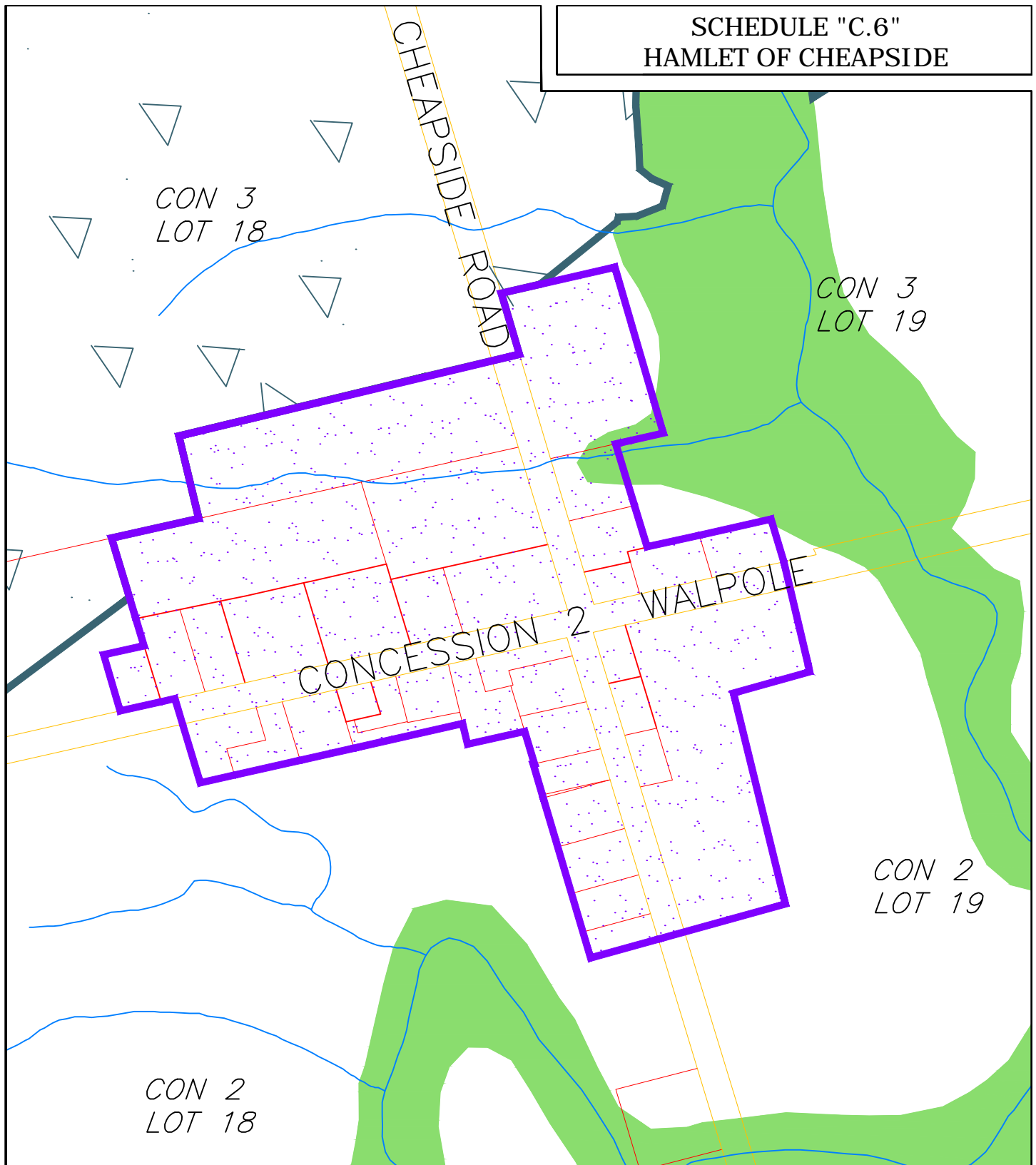

LEGEND:

CORE NATURAL ENVIRONMENT AREAS

RIVERINE HAZARD LANDS

AGRICULTURE

HAMLET

MINERAL AGGREGATE RESOURCE AREA

WATER COURSE

**HALDIMAND COUNTY
OFFICIAL PLAN**

DECISION DATE: JUNE 8, 2009



1 IN = 100 METRES



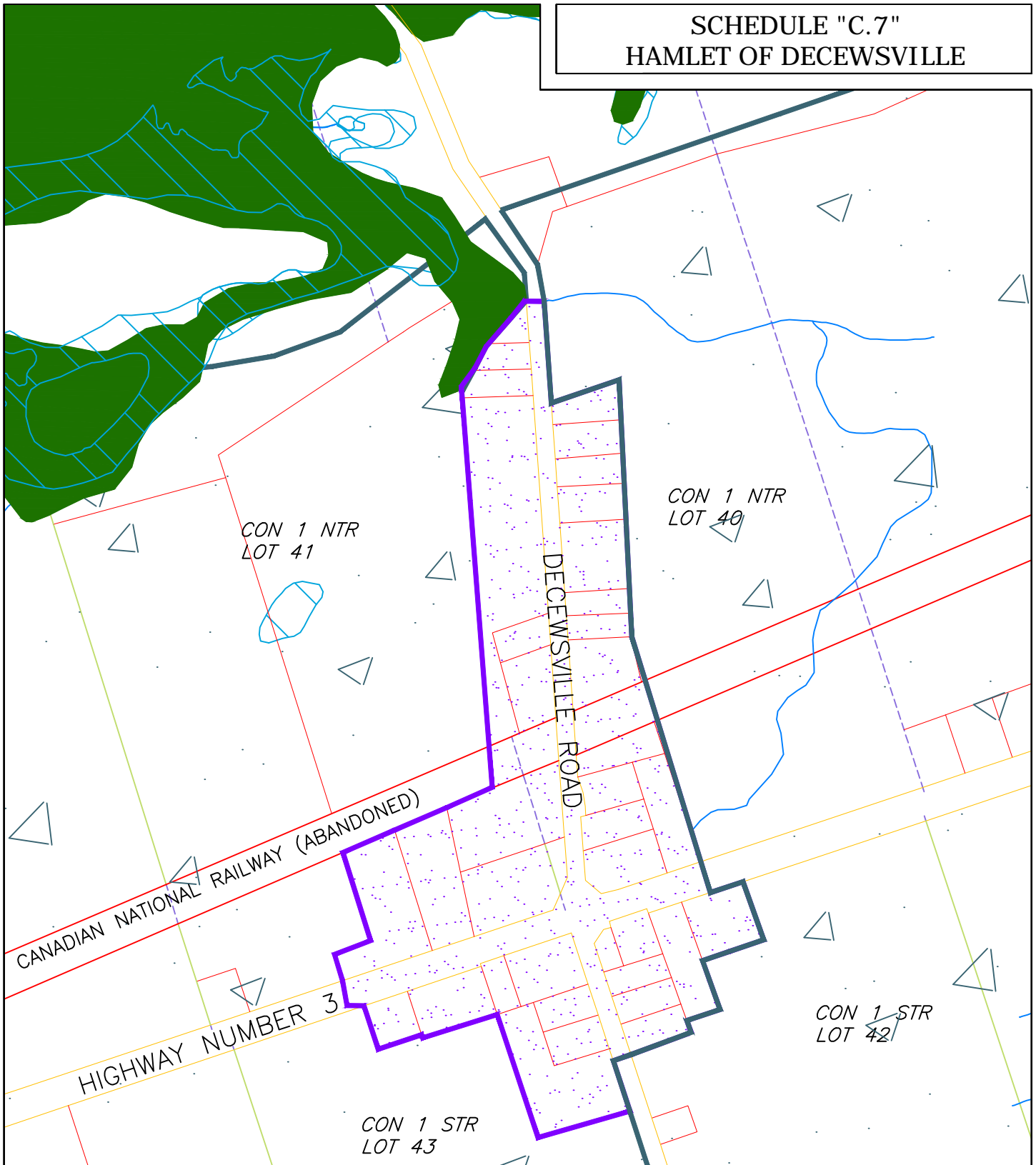

SCHEDULE "C.7"
HAMLET OF DECEWSVILLE



LEGEND:

CORE NATURAL ENVIRONMENT AREAS

-  PROVINCIALY SIGNIFICANT WETLANDS
-  RIVERINE HAZARD LANDS

NATURAL ENVIRONMENT AREAS

-  NATURAL ENVIRONMENT/WETLAND AREAS

-  HAMLET

-  MINERAL AGGREGATE RESOURCE AREA

-  AGRICULTURE

-  WATER COURSE

**HALDIMAND COUNTY
OFFICIAL PLAN**

DECISION DATE: JUNE 8, 2009







1 IN = 100 METRES

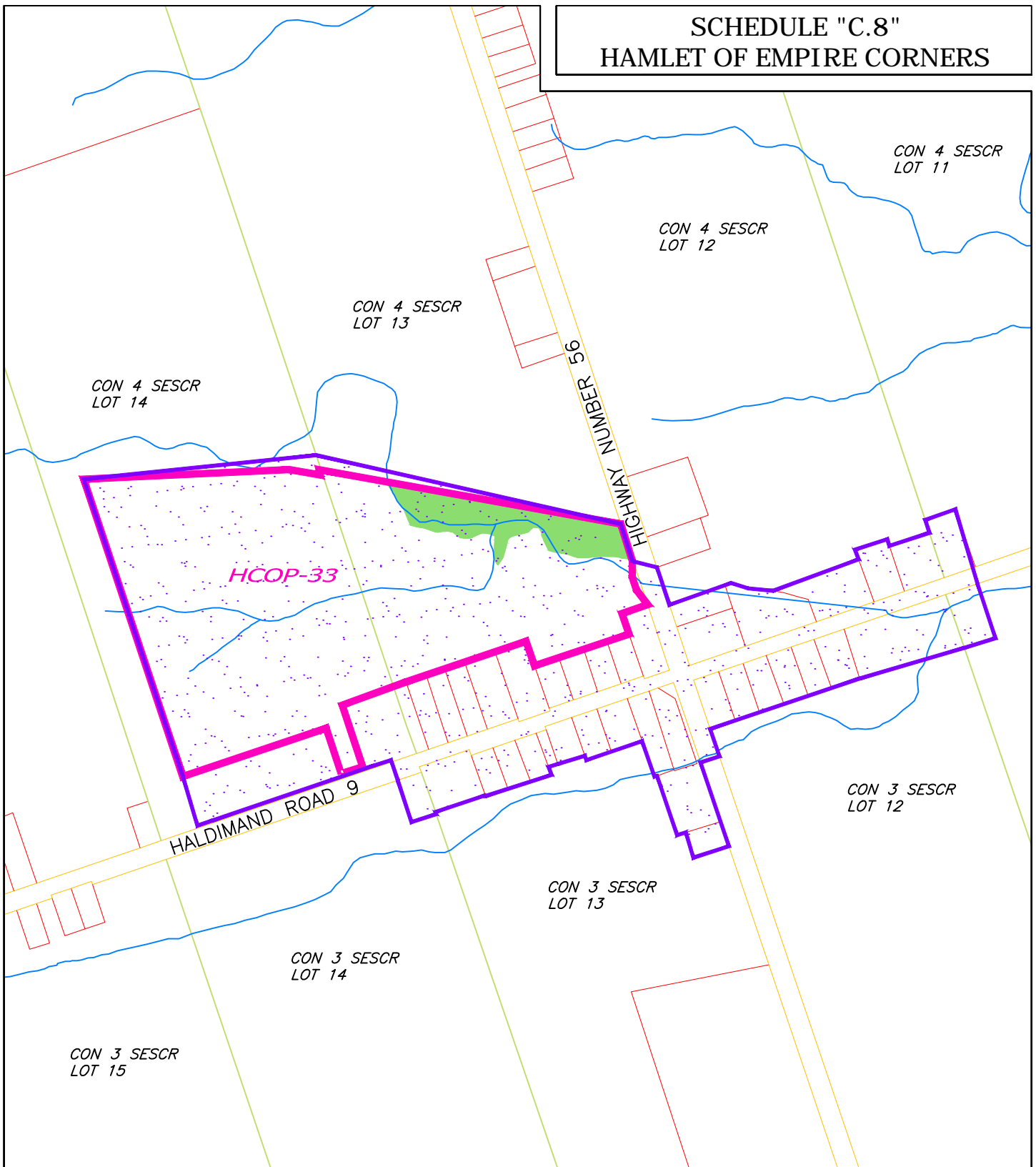

SCHEDULE "C.8" HAMLET OF EMPIRE CORNERS



LEGEND:

- | | |
|--|--|
|  CORE NATURAL ENVIRONMENT AREAS |  AGRICULTURE |
|  RIVERINE HAZARD LANDS |  SECTION NUMBER |
|  HAMLET |  WATER COURSE |

HALDIMAND COUNTY OFFICIAL PLAN

DECISION DATE: JUNE 8, 2009



1 IN = 150 METRES



**SCHEDULE "C.9"
HAMLET OF FISHERVILLE**

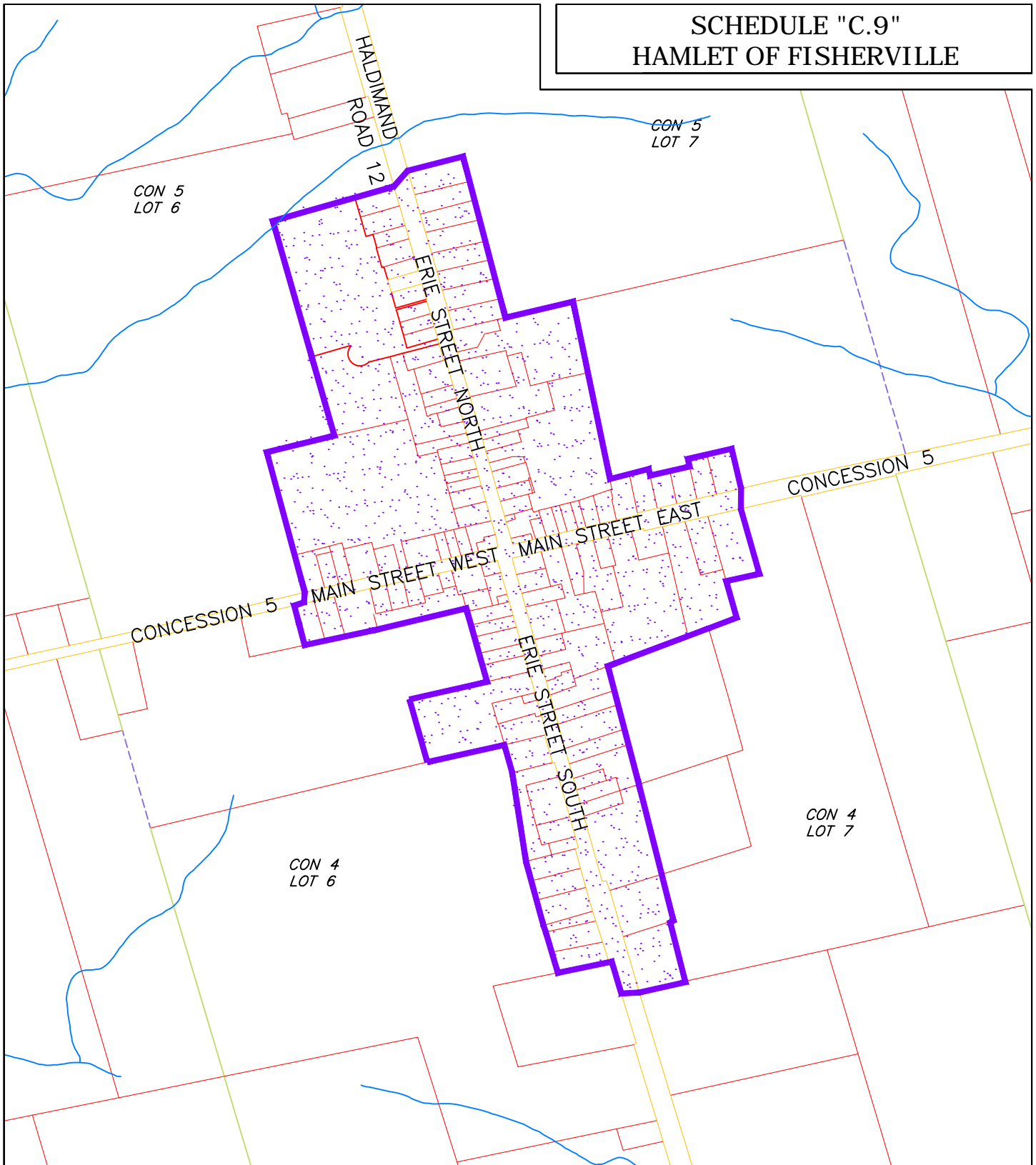

LEGEND:

-  HAMLET
-  AGRICULTURE

 WATER COURSE

**HALDIMAND COUNTY
OFFICIAL PLAN**

DECISION DATE: JUNE 9, 2008







1 IN = 200 METRES

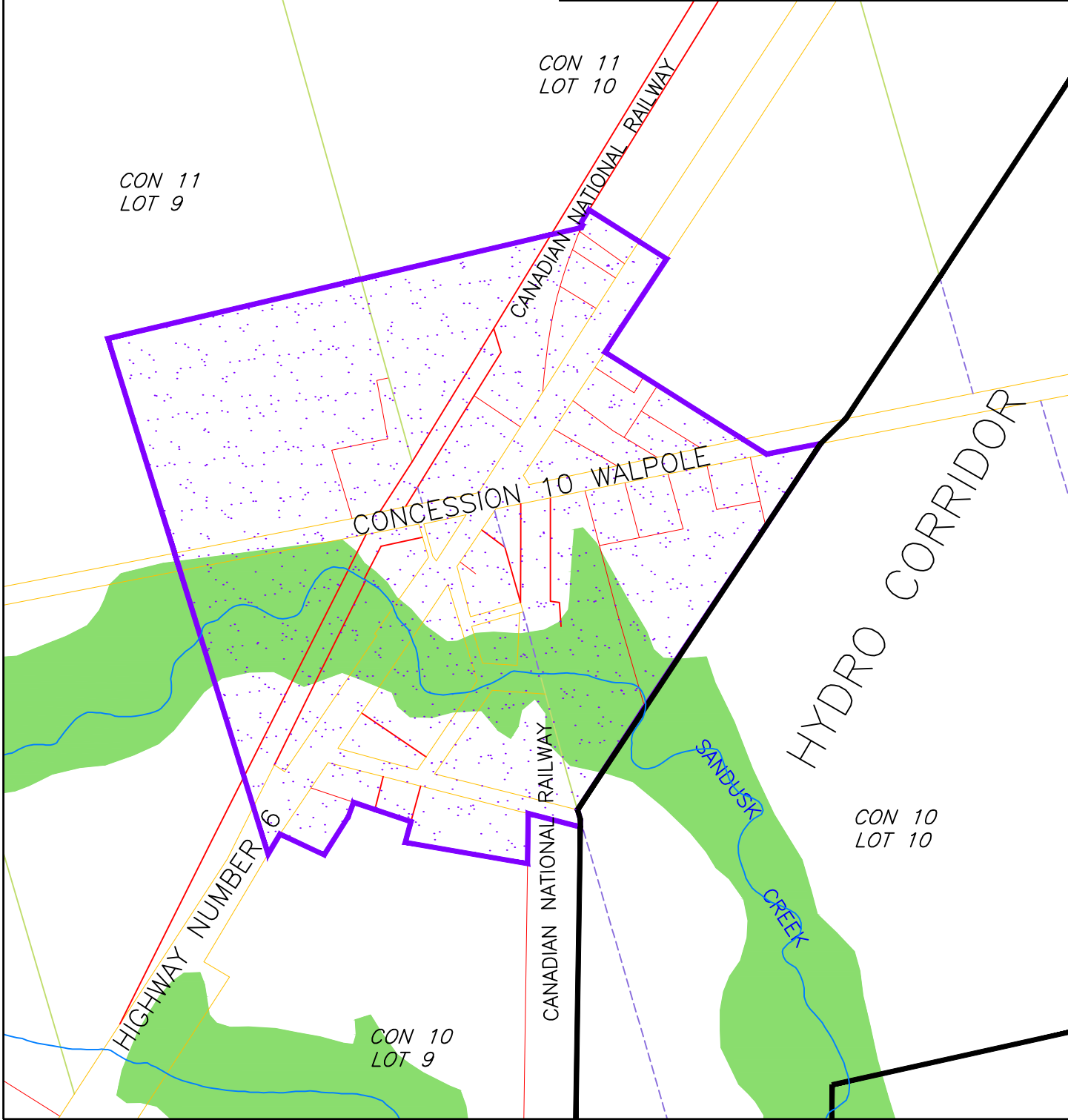

**SCHEDULE "C.10"
HAMLET OF GARNET**



LEGEND:

- | | |
|--|--|
|  CORE NATURAL ENVIRONMENT AREAS |  AGRICULTURE |
|  RIVERINE HAZARD LANDS |  WATER COURSE |
|  HAMLET | |

**HALDIMAND COUNTY
OFFICIAL PLAN**

DECISION DATE: JUNE 8, 2009



1 IN = 150 METRES



SCHEDULE "C.11" HAMLET OF KOHLER

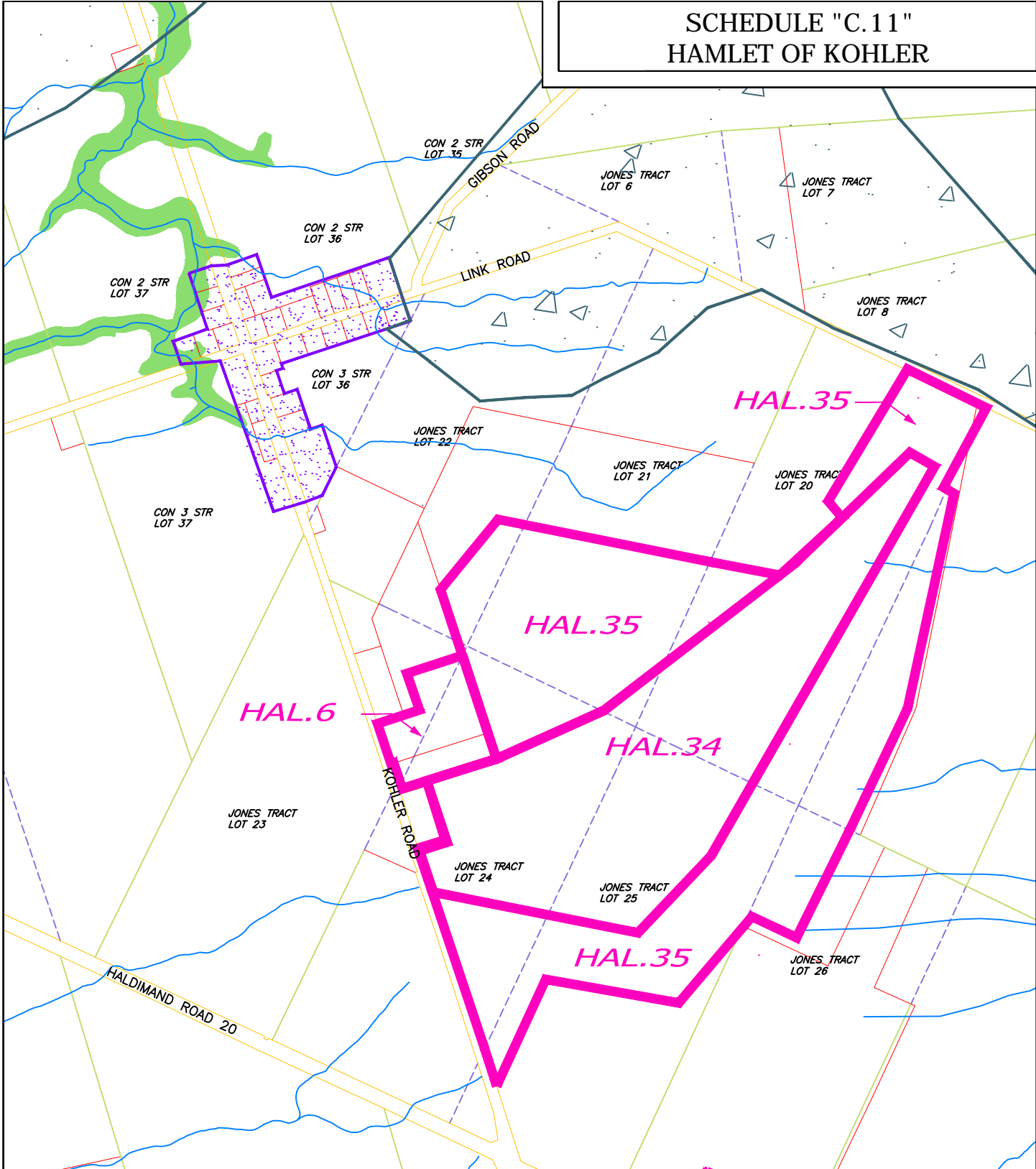

LEGEND:

CORE NATURAL ENVIRONMENT AREAS



RIVERINE HAZARD LANDS



MINERAL AGGREGATE
RESOURCE AREA



HAMLET



SITE SPECIFIC POLICY



AGRICULTURE



WATER COURSE

HALDIMAND COUNTY OFFICIAL PLAN

DECISION DATE: JUNE 8, 2009



1 IN = 300 METRES



SCHEDULE "C.12" HAMLET OF LOWBANKS

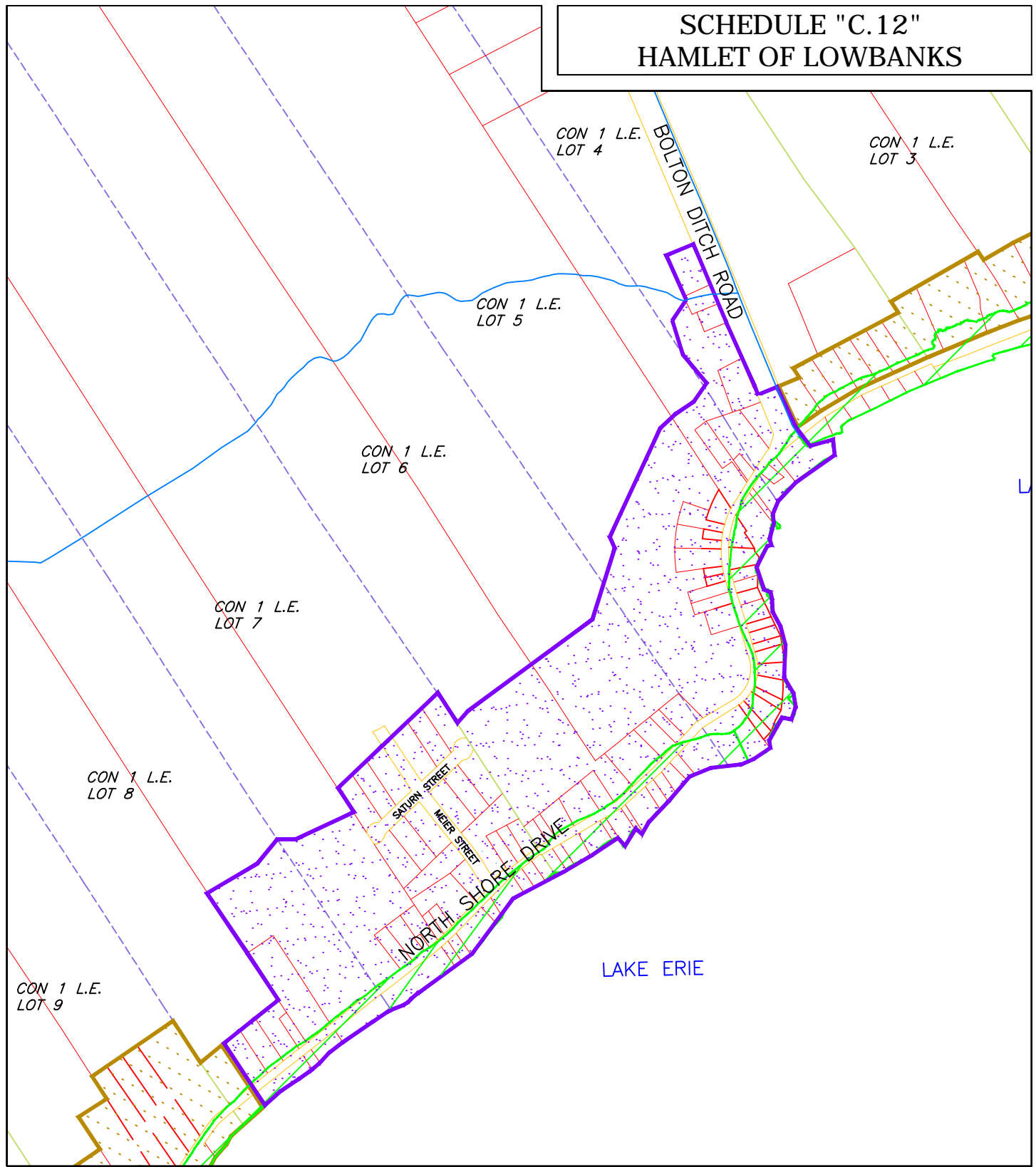

LEGEND:

NATURAL ENVIRONMENT AREAS

LAKESHORE HAZARD LANDS

HAMLET



RESORT RESIDENTIAL

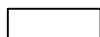

AGRICULTURE



WATER COURSE

HALDIMAND COUNTY OFFICIAL PLAN

DECISION DATE: JUNE 8, 2009





1 IN = 150 METRES

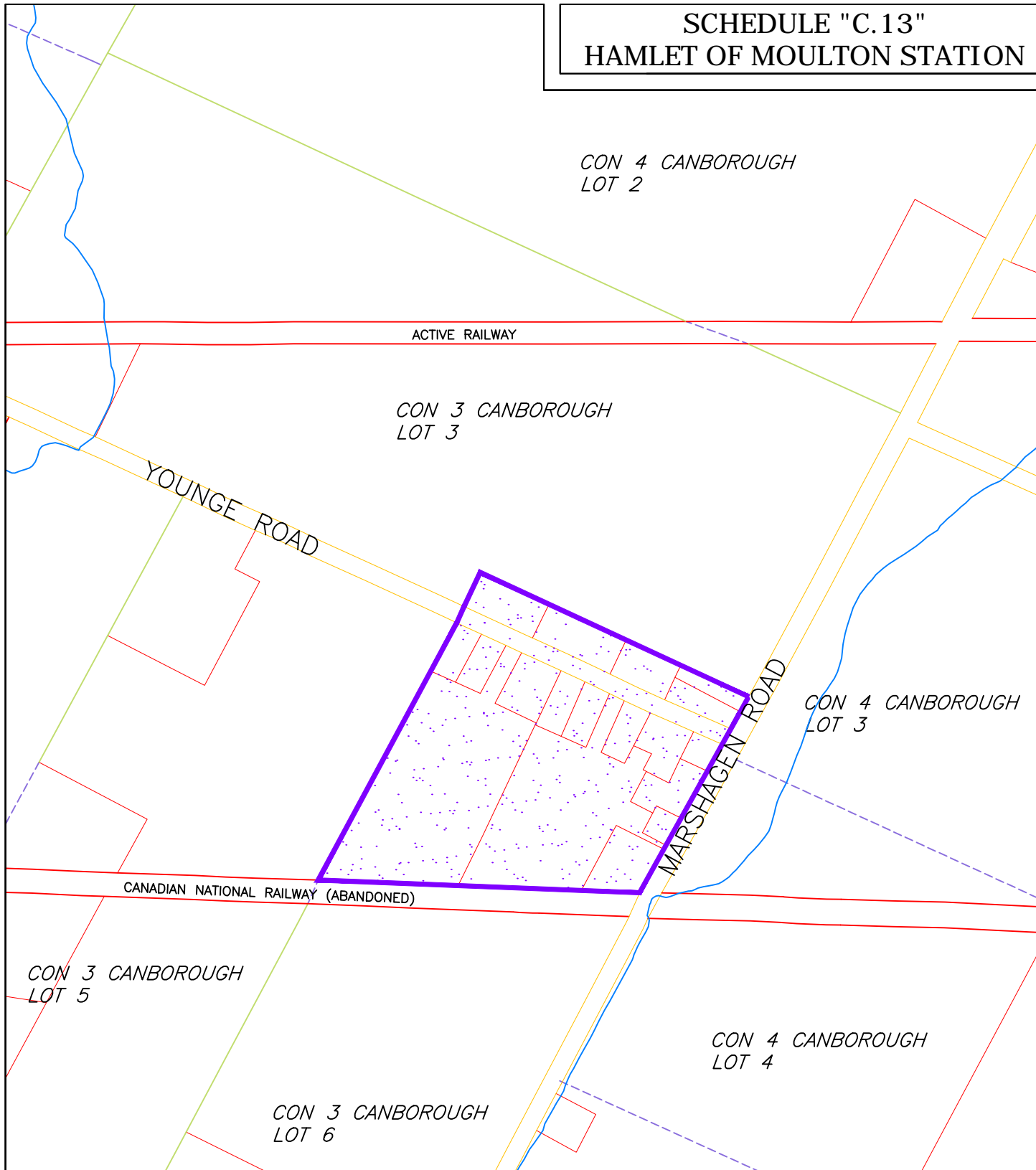

**SCHEDULE "C.13"
HAMLET OF MOULTON STATION**



LEGEND:

-  HAMLET
-  AGRICULTURE

 WATER COURSE

**HALDIMAND COUNTY
OFFICIAL PLAN**

DECISION DATE: JUNE 8, 2009



1 IN = 150 METRES



SCHEDULE "C.14"
HAMLET OF NANTICOKE

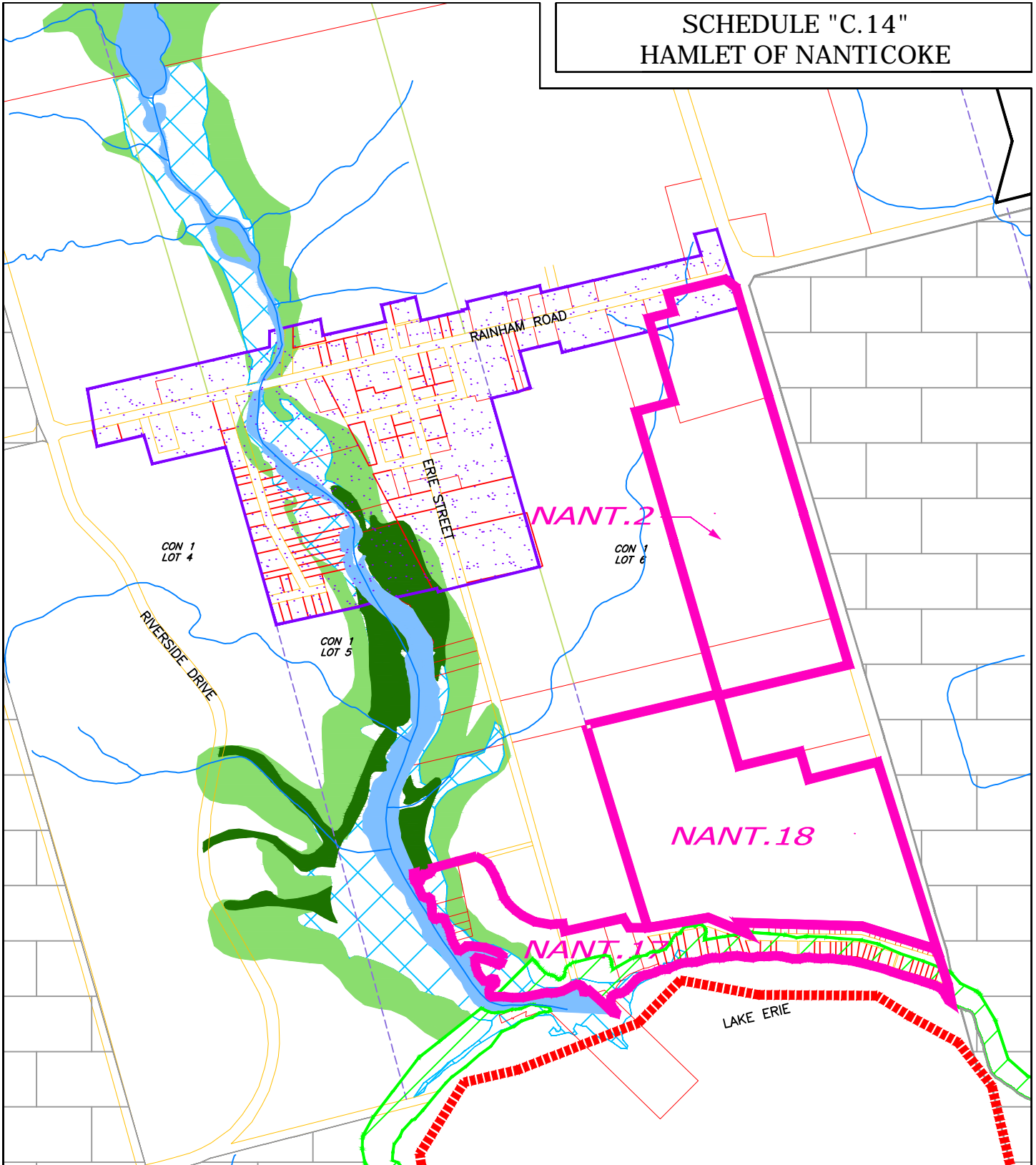



LEGEND:

CORE NATURAL ENVIRONMENT AREAS

-  PROVINCIALY SIGNIFICANT WETLANDS
-  RIVERINE HAZARD LANDS

NATURAL ENVIRONMENT AREAS

-  LAKESHORE HAZARD LANDS
-  FLOODWAY

 HAMLET

 AGRICULTURE

 HEAVY INDUSTRIAL

 INDUSTRIAL INFLUENCE AREA

 SECTION NUMBER

 WATER COURSE

**HALDIMAND COUNTY
OFFICIAL PLAN**

DECISION DATE: JUNE 8, 2009



1 IN = 300 METRES



**SCHEDULE "C.15"
HAMLET OF NELLES CORNERS**

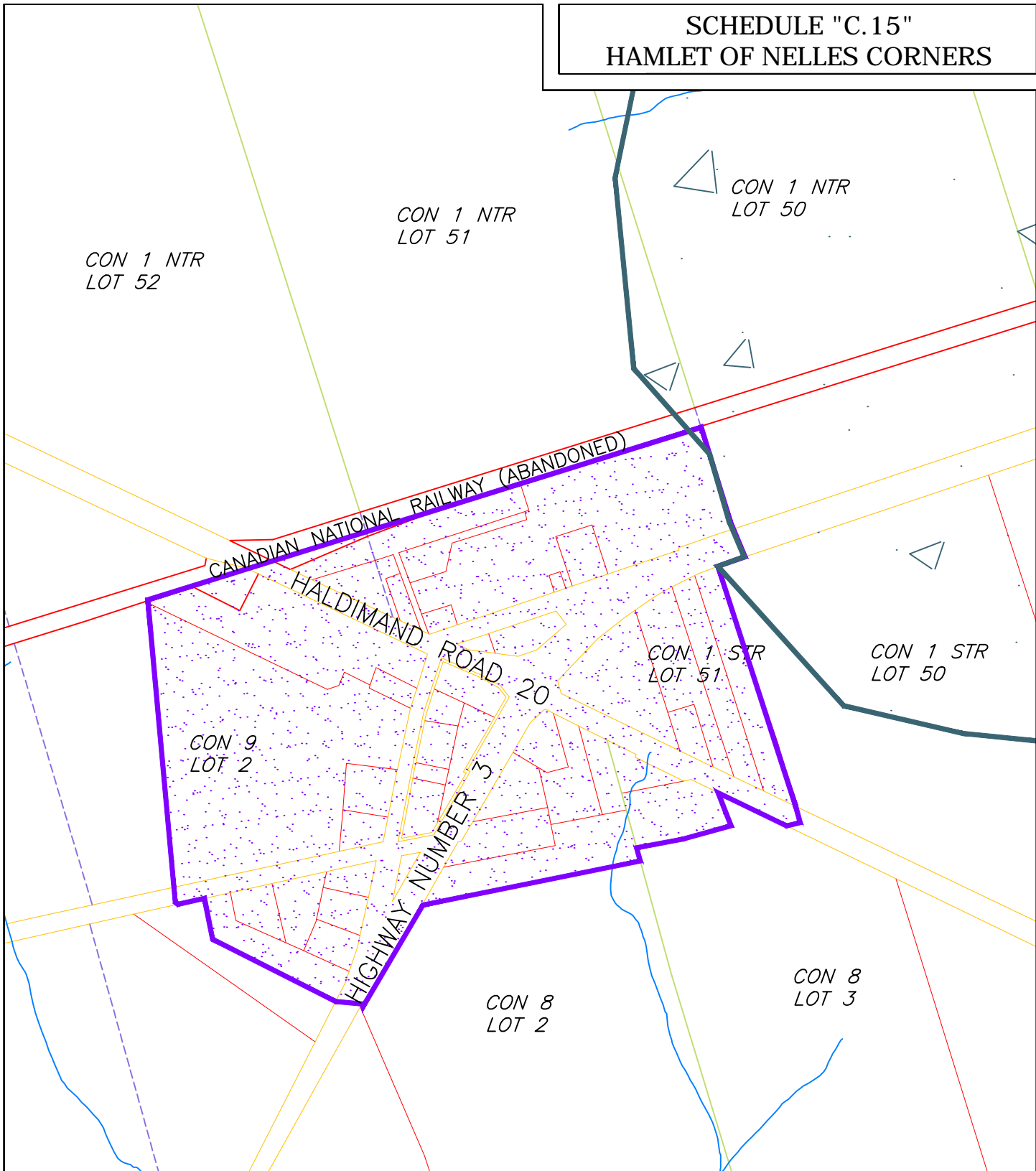

LEGEND:

 HAMLET

 AGRICULTURE

 MINERAL AGGREGATE RESOURCE AREA

 WATER COURSE

**HALDIMAND COUNTY
OFFICIAL PLAN**

DECISION DATE: JUNE 8, 2009



1 IN = 150 METRES



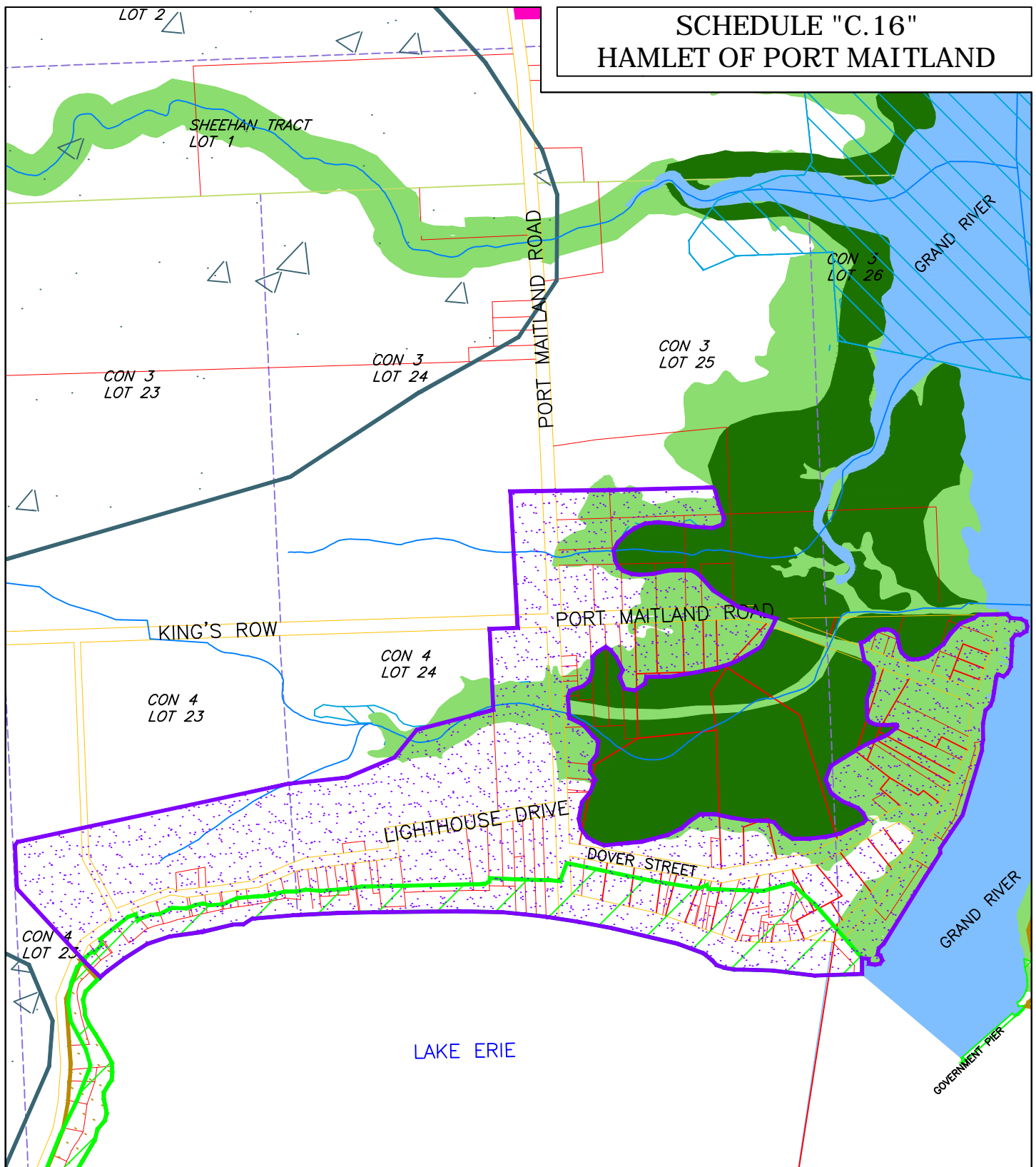

SCHEDULE "C.16" HAMLET OF PORT MAITLAND





LEGEND:

CORE NATURAL ENVIRONMENT AREAS

-  PROVINCIALY SIGNIFICANT WETLANDS
-  RIVERINE HAZARD LANDS

NATURAL ENVIRONMENT AREAS

-  LAKESHORE HAZARD LANDS
-  NATURAL ENVIRONMENT/WETLAND AREAS

 HAMLET

 RESORT RESIDENTIAL

 AGRICULTURE

 MINERAL AGGREGATE RESOURCE AREA

HALDIMAND COUNTY OFFICIAL PLAN

DECISION DATE: JUNE 8, 2009

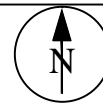

1 IN = 200 METRES



**SCHEDULE "C.17"
HAMLET OF RAINHAM CENTRE**

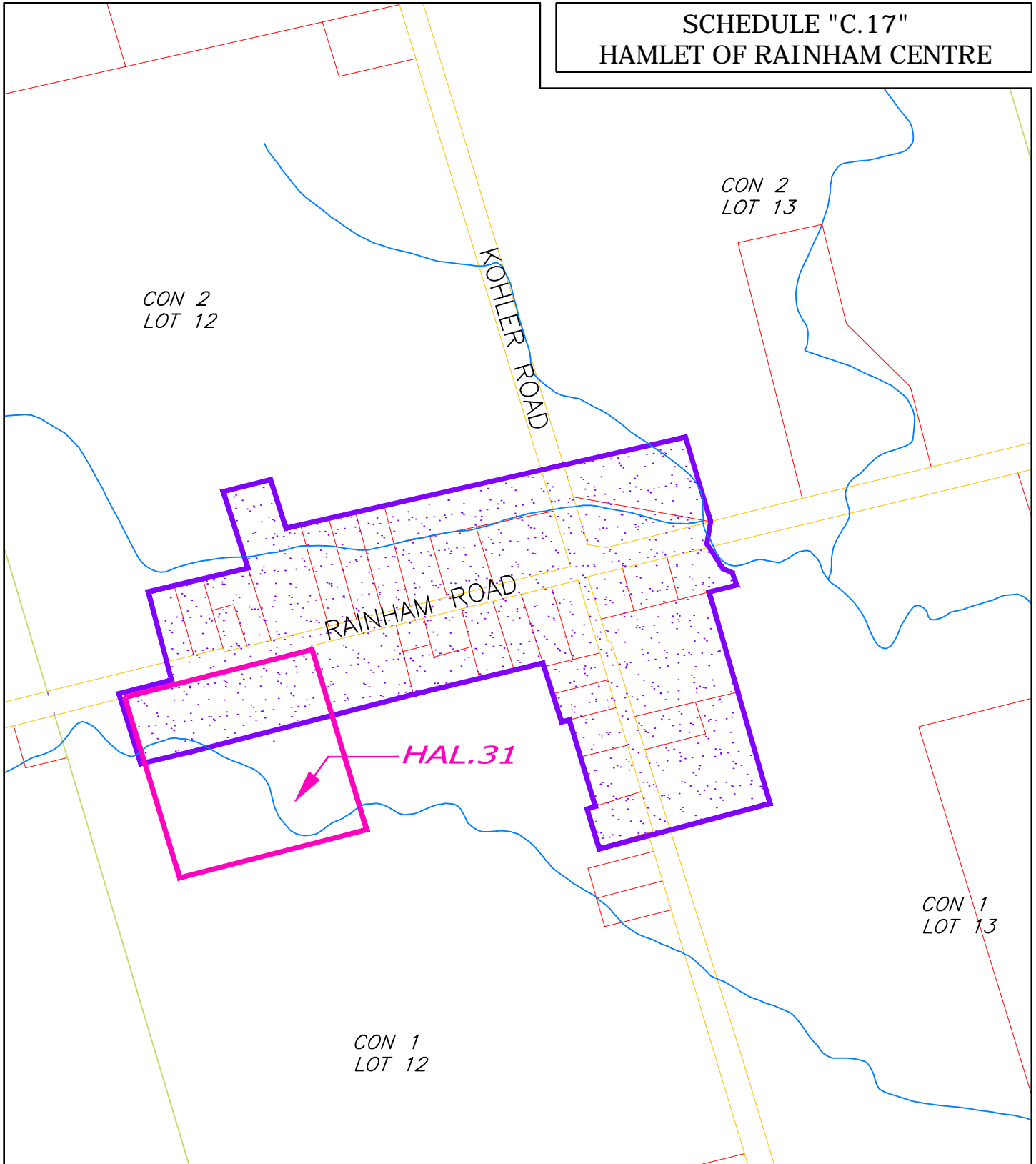

LEGEND:

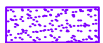

HAMLET

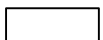

AGRICULTURE



SECTION NUMBER SITE SPECIFIC POLICY



WATER COURSE

**HALDIMAND COUNTY
OFFICIAL PLAN**

DECISION DATE: JUNE 8, 2009



1 IN = 150 METRES



SCHEDULE "C.18"
HAMLET OF SELKIRK

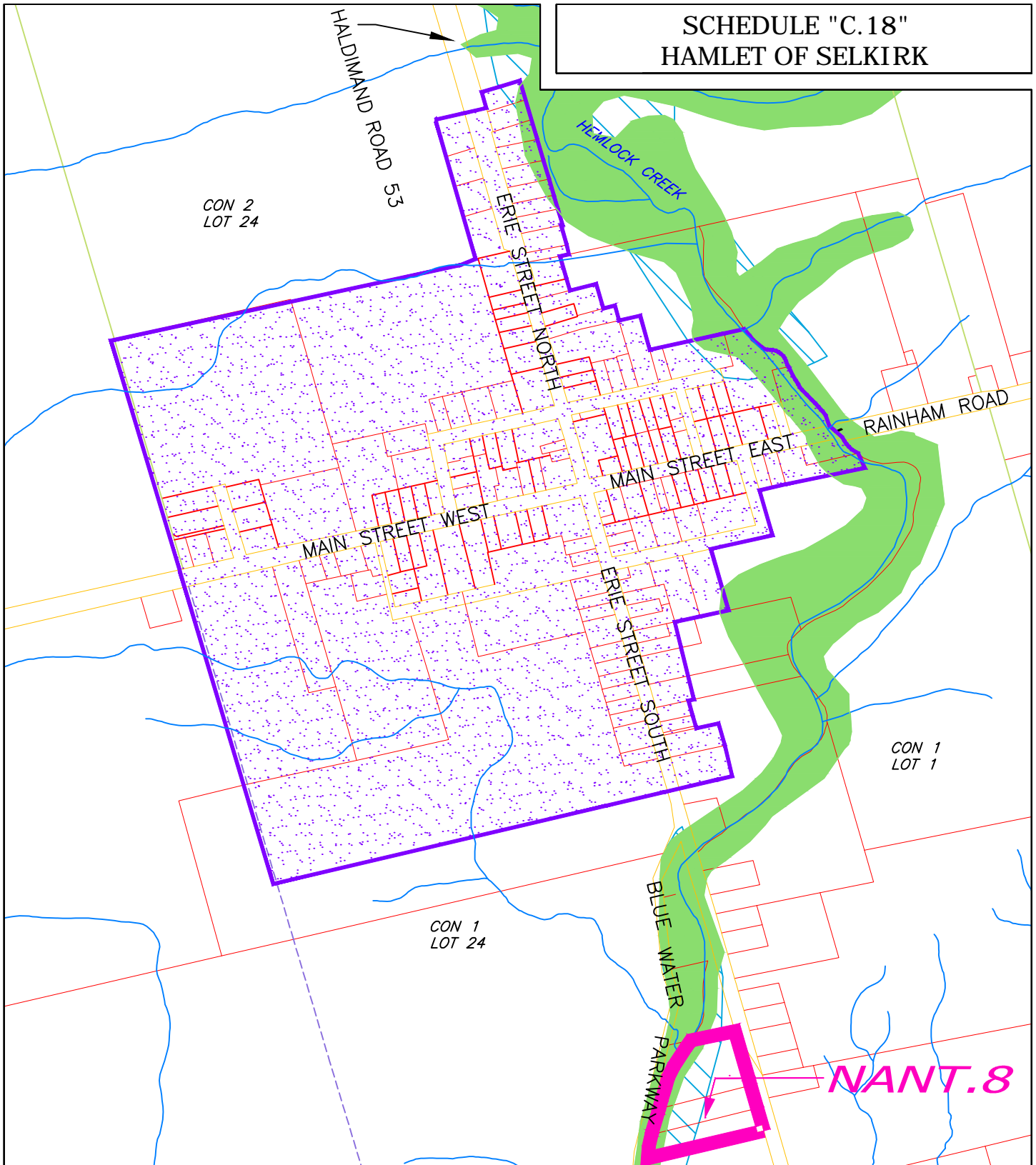

LEGEND:

CORE NATURAL ENVIRONMENT AREAS



RIVERINE HAZARD LANDS

NATURAL ENVIRONMENT AREAS



NATURAL ENVIRONMENT/
WETLAND AREAS



HAMLET

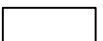

AGRICULTURE

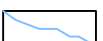

WATER COURSE

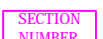

SITE SPECIFIC POLICY

HALDIMAND COUNTY
OFFICIAL PLAN

DECISION DATE: JUNE 8, 2009









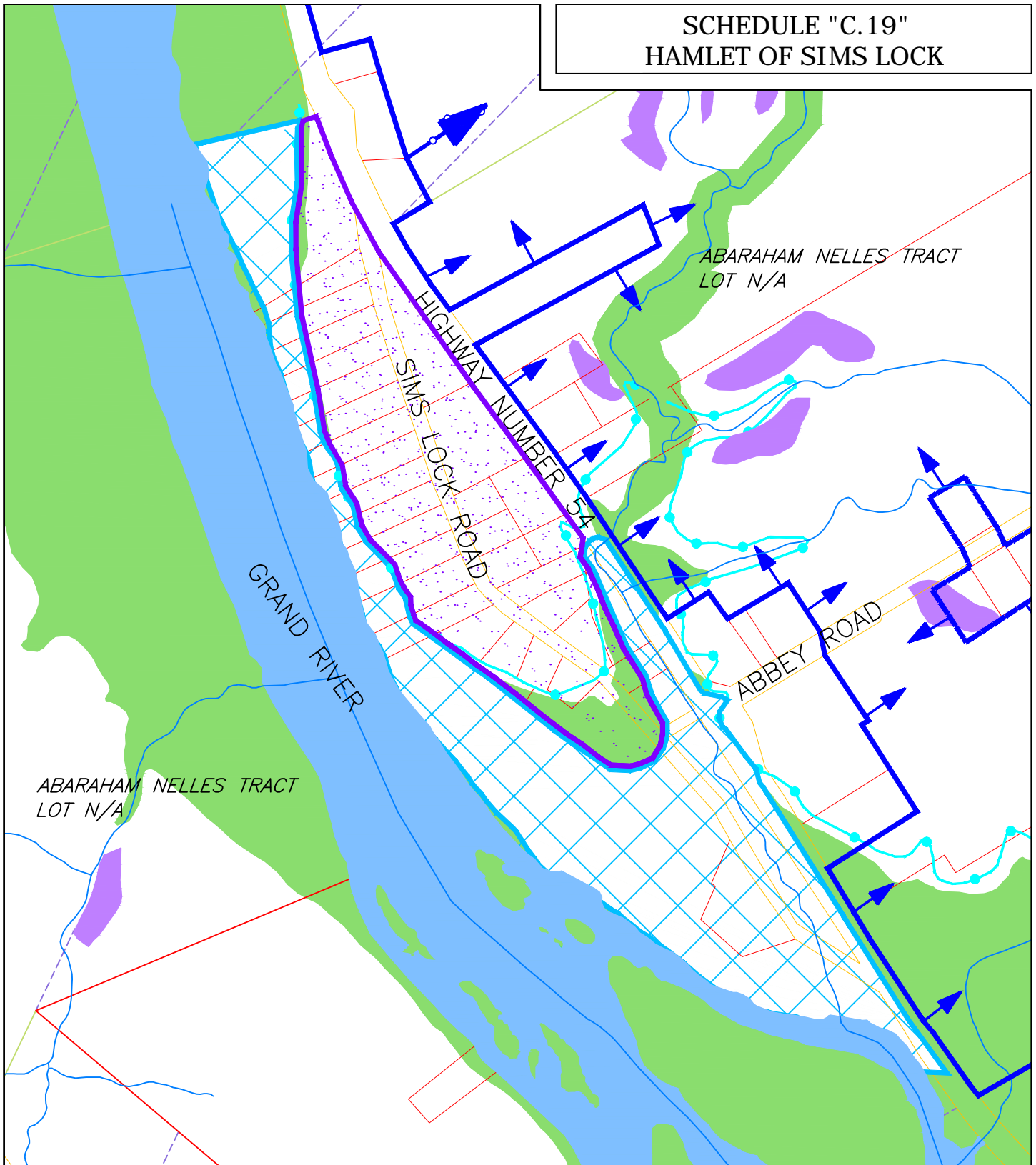



1 IN = 200 METRES



**SCHEDULE "C.19"
HAMLET OF SIMS LOCK**



| LEGEND: | | | |
|---|--------------------------------|---|-----------------|
|  | CORE NATURAL ENVIRONMENT AREAS |  | AGRICULTURE |
|  | RIVERINE HAZARD LANDS |  | HAMLET |
|  | NATURAL ENVIRONMENT AREAS |  | GYPSUM DEPOSITS |
|  | FLOODWAY |  | WATER COURSE |
|  | OTHER HAZARD LANDS | | |
|  | FLOODWAY/FLOOD FRINGE | | |

**HALDIMAND COUNTY
OFFICIAL PLAN**

DECISION DATE: JUNE 8, 2009



1 IN = 150 METRES



**SCHEDULE "C.20"
HAMLET OF SOUTH CAYUGA**

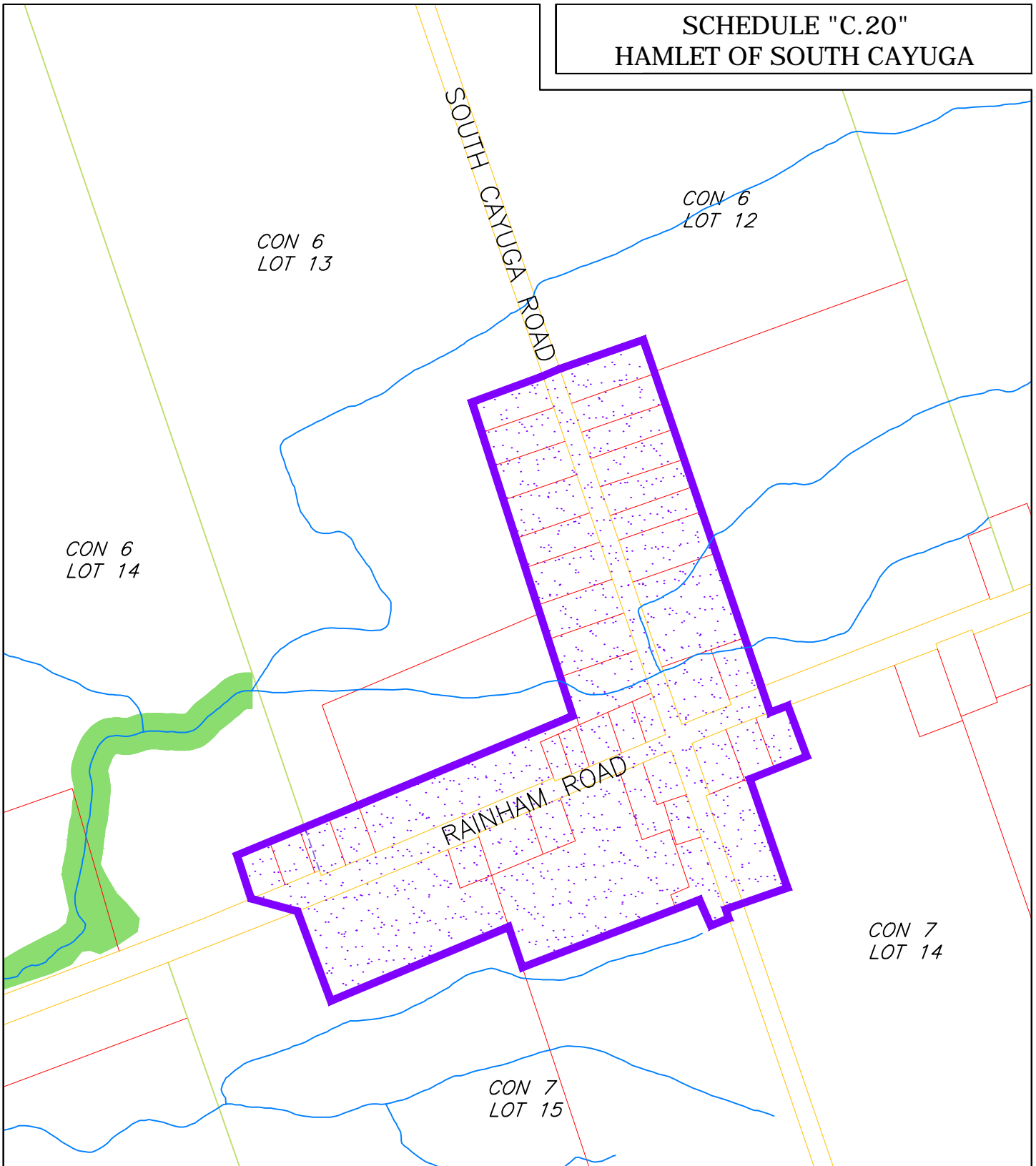

LEGEND:

CORE NATURAL ENVIRONMENT AREAS



AGRICULTURE



RIVERINE HAZARD LANDS

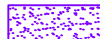

HAMLET

**HALDIMAND COUNTY
OFFICIAL PLAN**

DECISION DATE: JUNE 8, 2009



1 IN = 150 METRES



SCHEDULE "C.21"
HAMLET OF SPRINGVALE

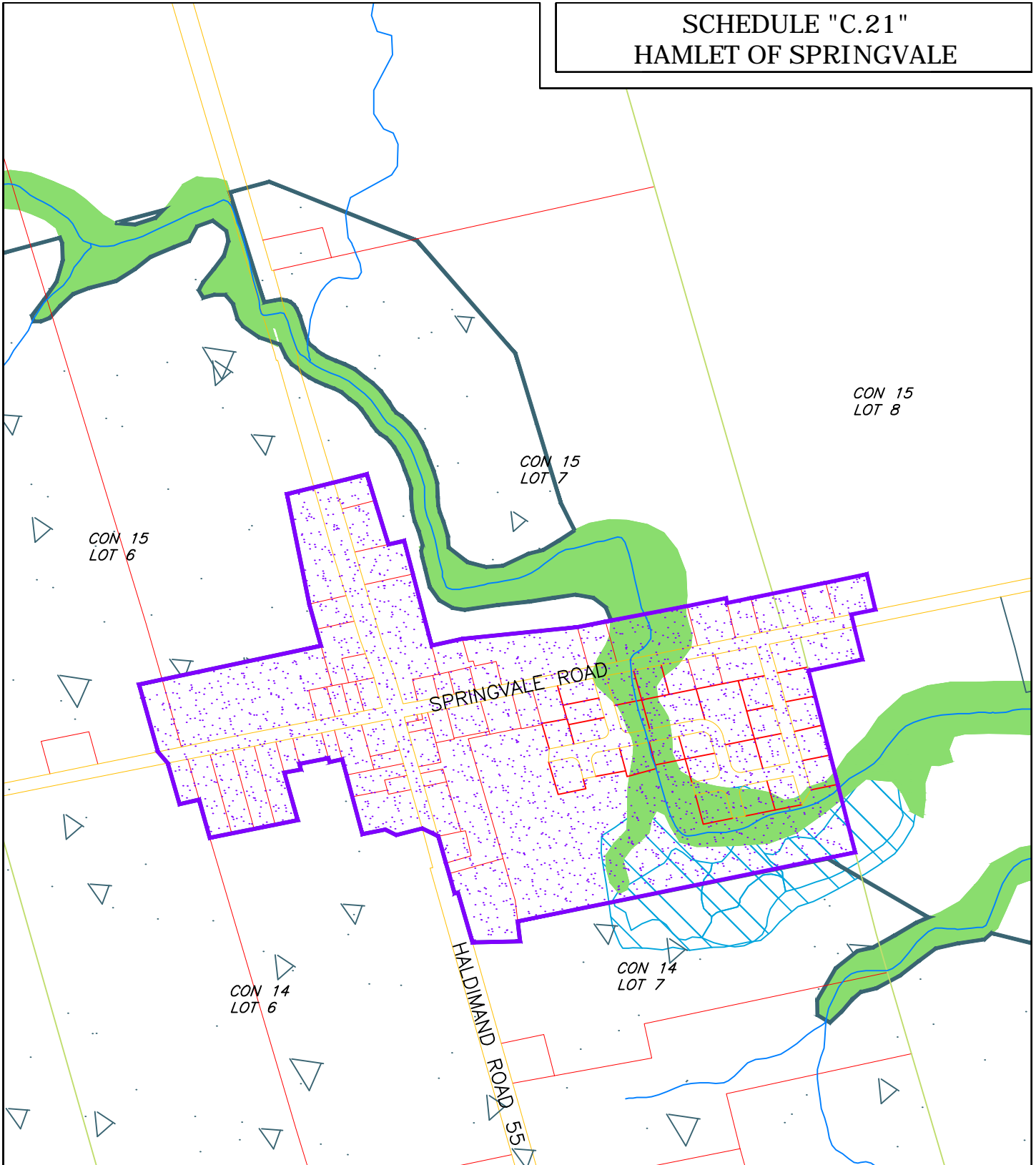

LEGEND:

CORE NATURAL ENVIRONMENT AREAS



RIVERINE HAZARD LANDS

NATURAL ENVIRONMENT AREAS



NATURAL ENVIRONMENT/WETLAND AREAS



HAMLET



AGRICULTURE



MINERAL AGGREGATE RESOURCE AREA



WATER COURSE

HALDIMAND COUNTY
OFFICIAL PLAN

DECISION DATE: JUNE 8, 2009



1 IN = 200 METRES



SCHEDULE "C.22" HAMLET OF STROMNESS

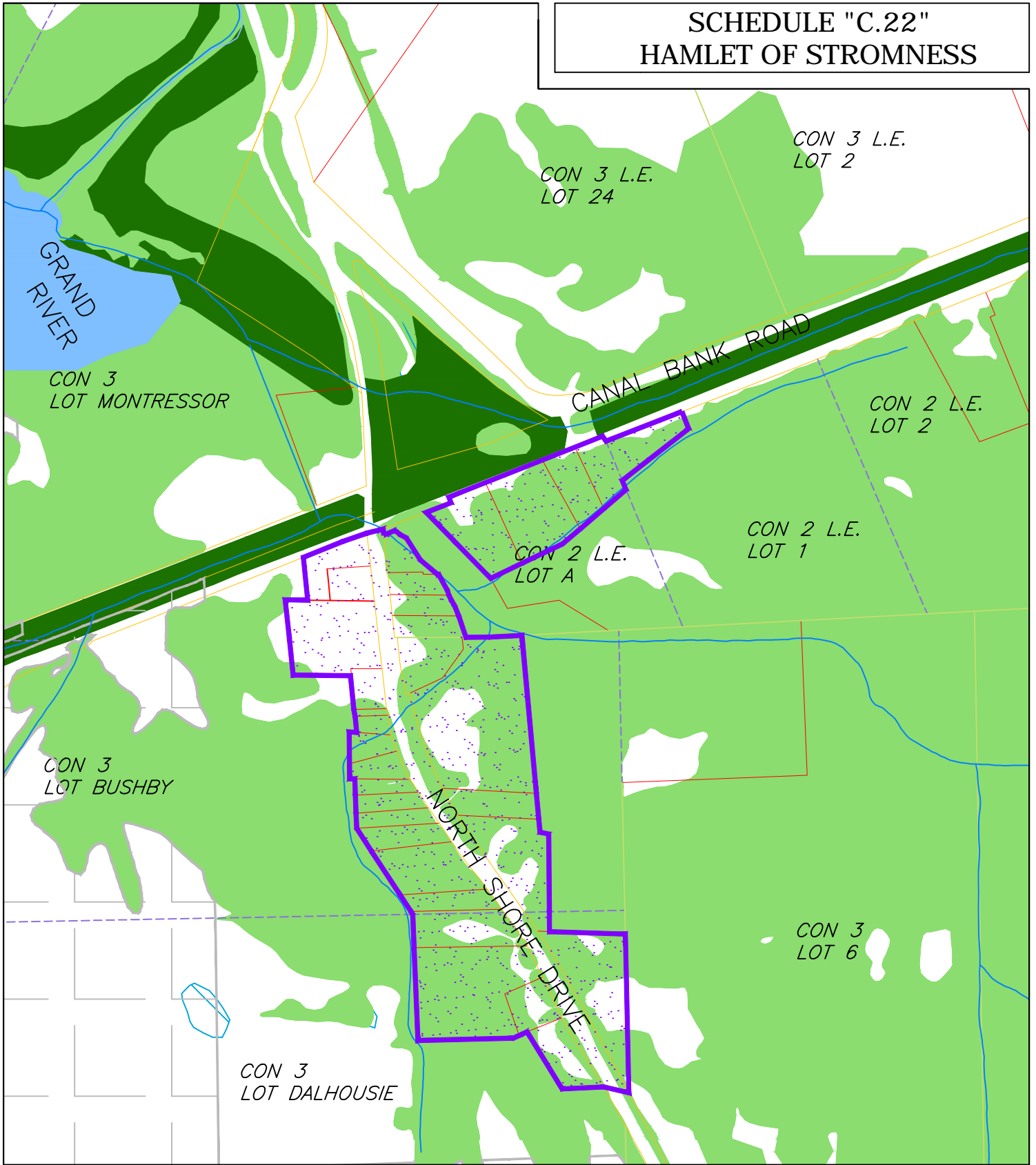

LEGEND:

CORE NATURAL ENVIRONMENT AREAS



PROVINCIALY SIGNIFICANT WETLANDS



RIVERINE HAZARD LANDS

NATURAL ENVIRONMENT AREAS



NATURAL ENVIRONMENT/WETLAND AREAS



HAMLET



RURAL INDUSTRIAL



AGRICULTURE



WATER COURSE

HALDIMAND COUNTY OFFICIAL PLAN

DECISION DATE: JUNE 8, 2009

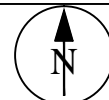

1 IN = 150 METRES



SCHEDULE "C.23"
HAMLET OF SWEETS CORNERS

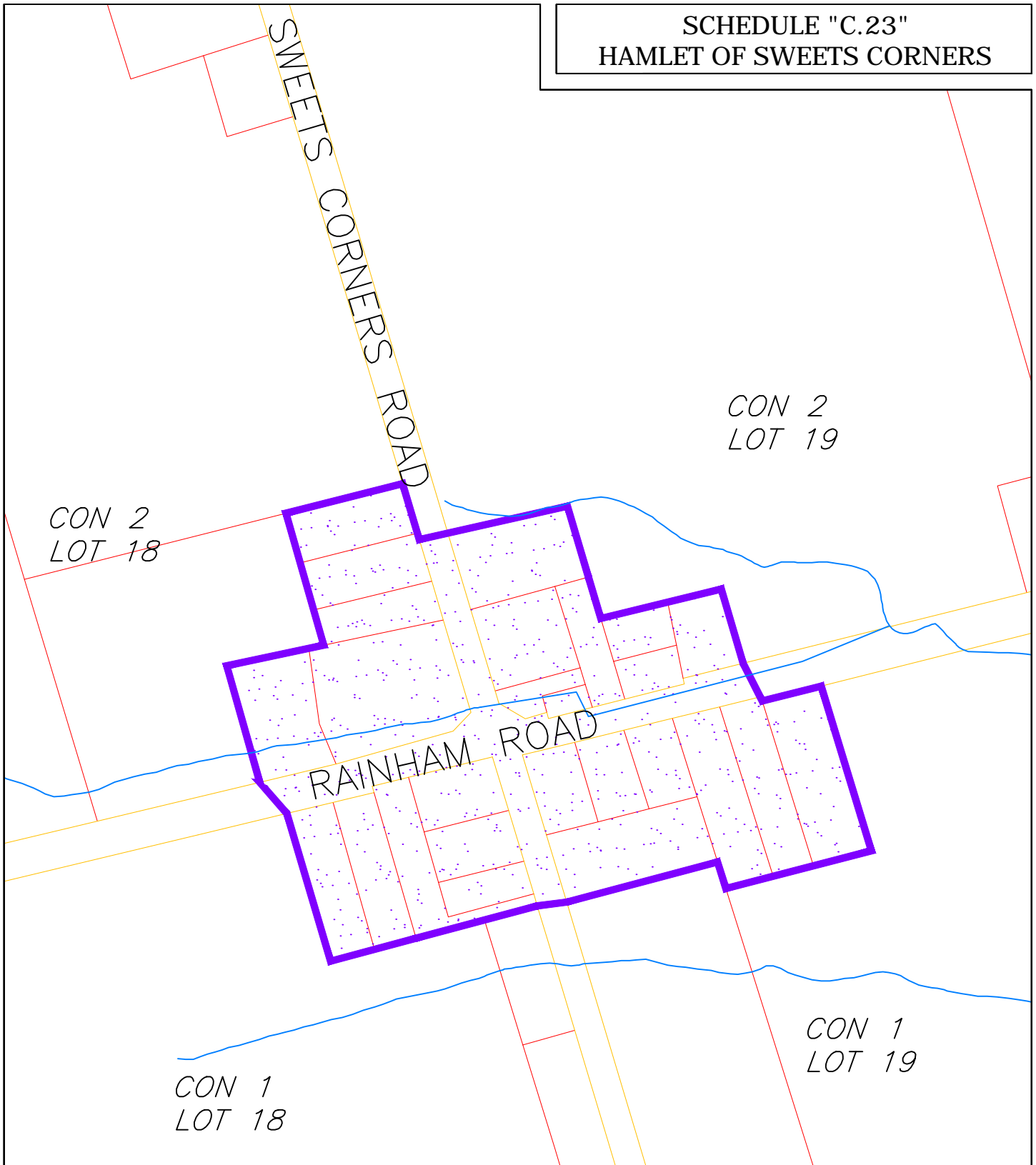

LEGEND:

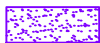

HAMLET



WATER COURSE



AGRICULTURE

HALDIMAND COUNTY
OFFICIAL PLAN

DECISION DATE: JUNE 8, 2009



1 IN = 100 METRES



SCHEDULE "C.24" HAMLET OF UNITY SIDE ROAD

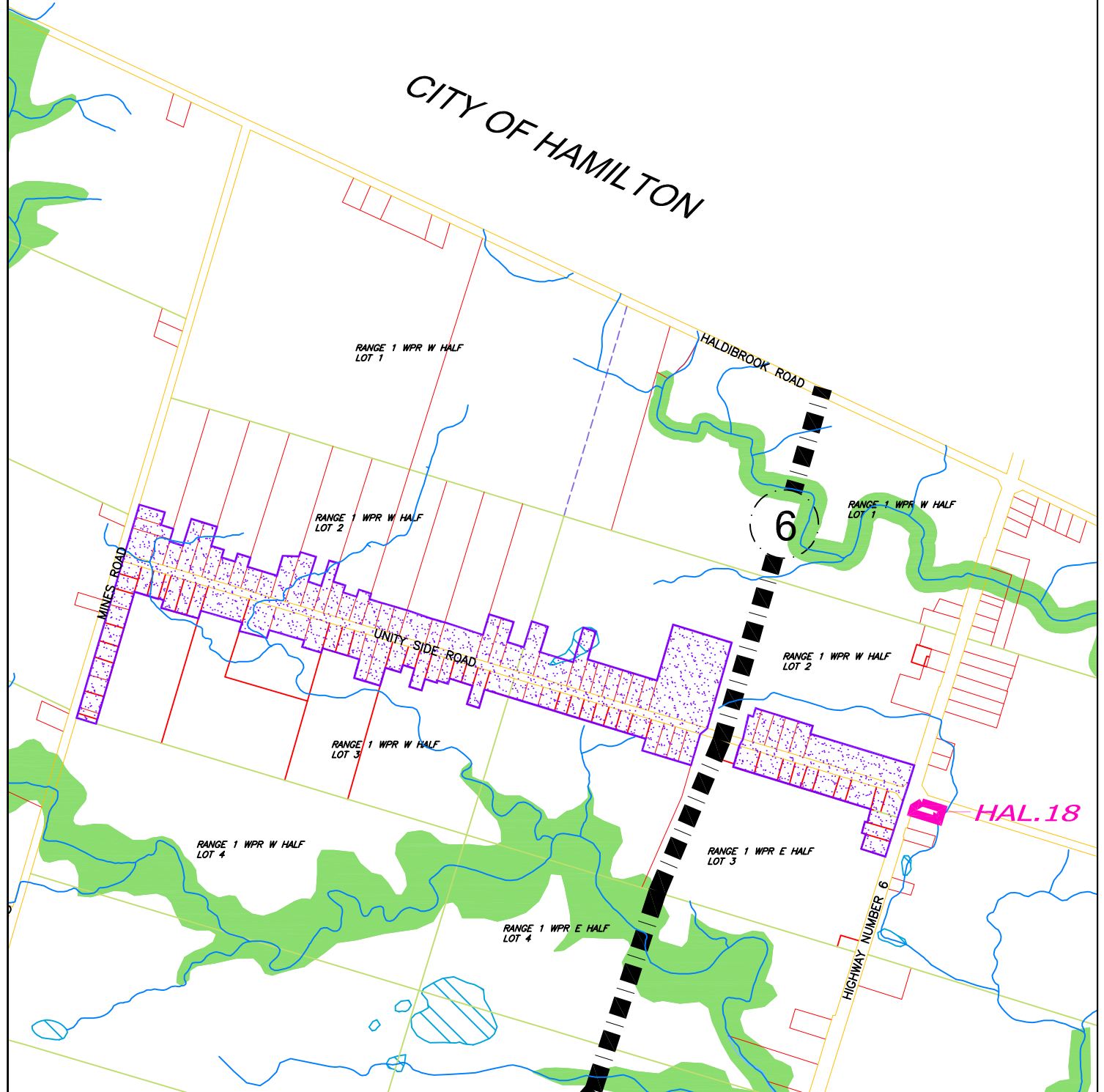

LEGEND:

CORE NATURAL ENVIRONMENT AREAS

RIVERINE HAZARD LANDS

NATURAL ENVIRONMENT AREAS

NATURAL ENVIRONMENT/WETLAND AREAS

HAMLET

AGRICULTURE

SITE SPECIFIC POLICY

WATER COURSE

FUTURE HIGHWAY 6
EXTENSION

HALDIMAND COUNTY OFFICIAL PLAN

DECISION DATE: JUNE 8, 2009







1 IN = 150 METRES

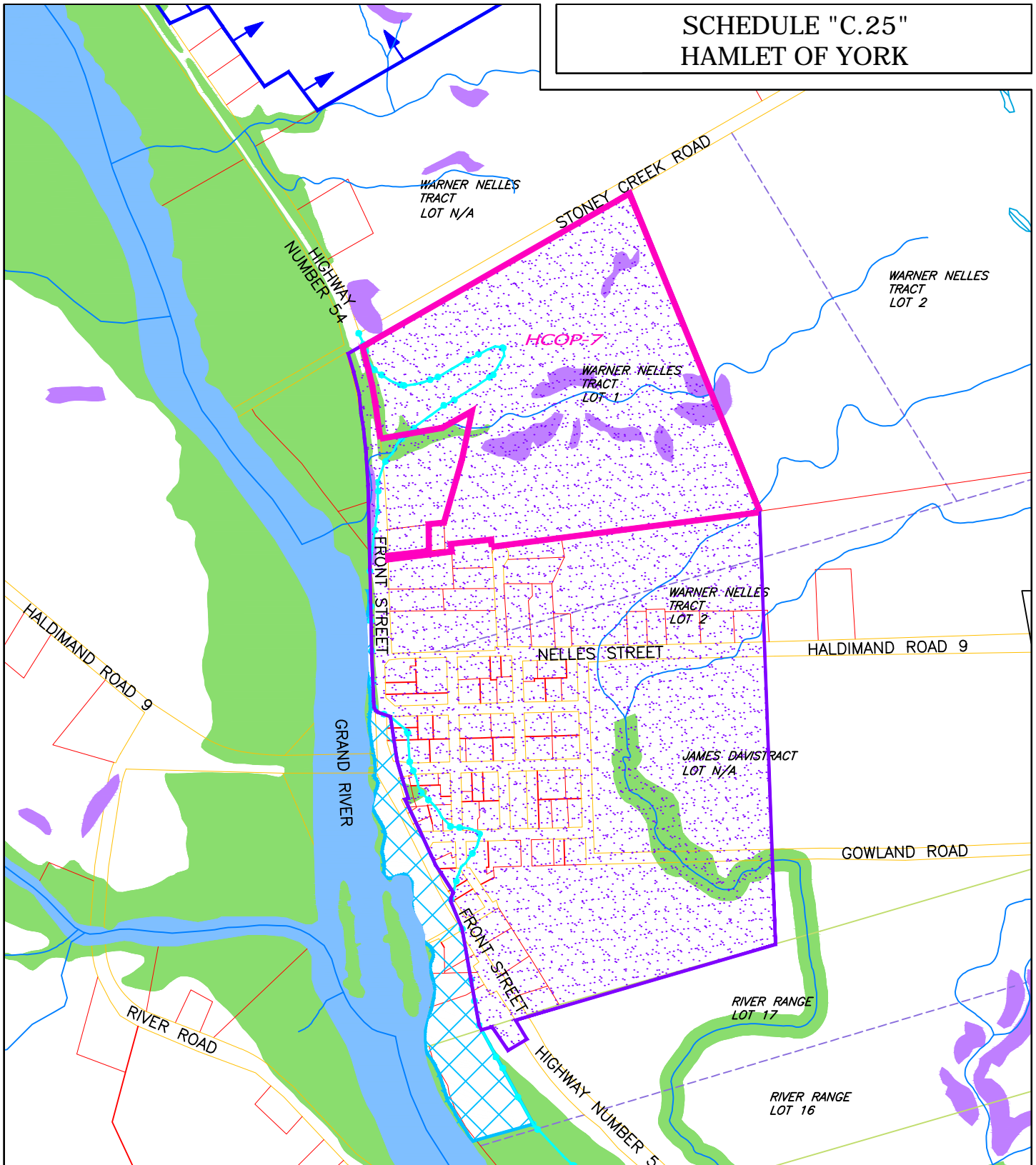





SCHEDULE "C.25" HAMLET OF YORK



LEGEND:

-  CORE NATURAL ENVIRONMENT AREAS
-  RIVERINE HAZARD LANDS
-  HAMLET
-  AGRICULTURE
-  GYPSUM DEPOSITS

NATURAL ENVIRONMENT AREAS

-  FLOODWAY
-  OTHER HAZARD LANDS
-  FLOODWAY/FLOOD FRINGE
-  NATURAL ENVIRONMENT/WETLAND AREAS

 SITE SPECIFIC POLICY

HALDIMAND COUNTY OFFICIAL PLAN

DECISION DATE: JUNE 8, 2009



1 IN = 250 METRES

